

mobiado

PROFESSIONAL



2 0 0 5

Mobiado

Mobiado

First edition (Jan 2005)

This manual is published by Bonac Innovation Corporation, without any warranty. Improvements and/or changes to this manual made necessary by typographical errors, inaccuracies of current information, or improvements to programs and/or equipment, may be made by Bonac Innovation Corporation at any time and without notice. However, any such changes shall be incorporated into new editions of this manual.

All rights reserved.

©Bonac Innovation Corporation, 2005

Code Information

A security code protects your phone from unauthorized use. It is preset to 12345.

1. Getting Started

▪ SIM card installation

Be careful not to damage the SIM card when installing and removing. Keep out of the reach of small children.

Make sure the phone is turned off and remove any enhancements.

Press and hold the two release buttons, and lift the battery cover.

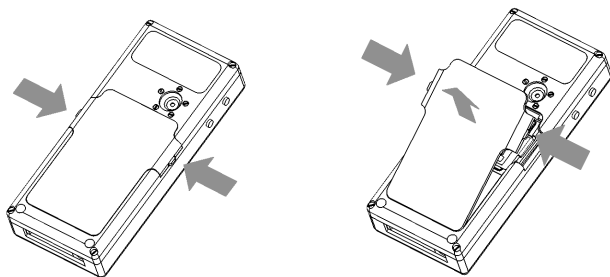

Remove battery by lifting.

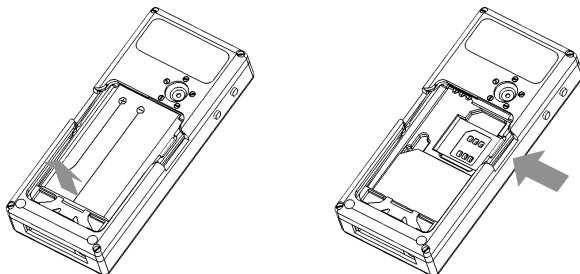

Pull up the locking clip.

Insert the SIM card. Make sure the golden contact area is facing downwards.

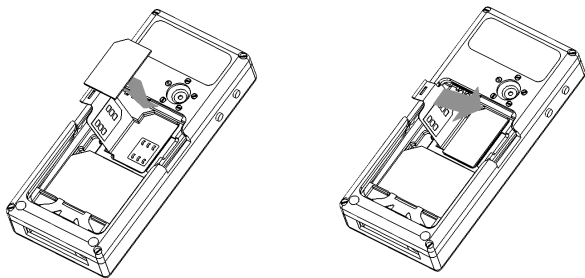

Close the locking clip.

Replace battery.

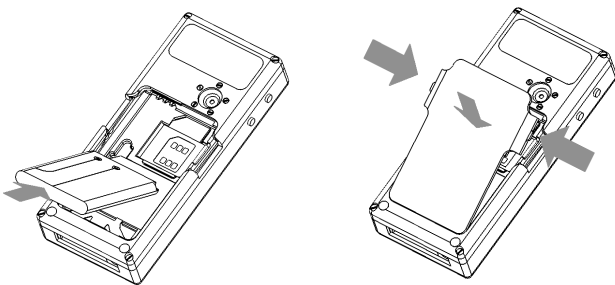

Press and hold the two release buttons and place the battery cover back in place.

▪ Charging the battery

Connect the charger lead to the bottom of your phone, and connect the charger plug into your wall socket.

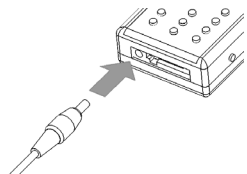

If your battery is completely flat, it may take a few minutes for the charging to begin or for before any calls can be made.

▪ Switching the phone on and off

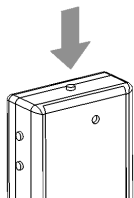

Press and hold the power button. If the phone asks for a PIN code, key in the PIN code and press **OK**.

▪ Normal operating position

Do not place fingers on RF window when operating your phone. Your phone has a built in antenna, and as with any radio transmitting device, contact with the antenna might disrupt the signal.

▪ Installing multimedia card

Use only compatible multimedia (MMC) cards. Other media types (such as SD cards) are not compatible and may damage your phone as well as your incompatible card.

Remove your battery cover and battery as show in the “SIM card installation” section.

Place the MMC card in the card holder as shown below. Make sure the golden contacts are facing downwards.

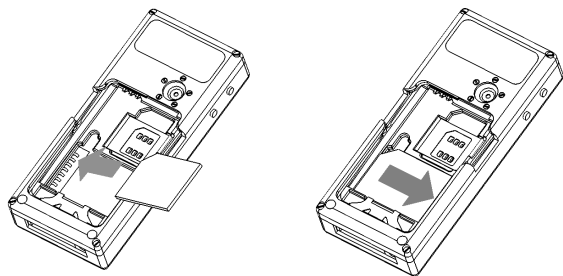

2. Mobiado Professional 2005





3. General Use

▪ Making a call and organizing contacts

Type in the phone number (press **Clear** to delete any incorrect characters).

For international calls, press ***+** twice for the “+” symbol (this replaces the international access code). Type in the country code without the leading “0”, if necessary, and then the number.



Press  to call.

Press  to end or cancel the call.

Search for a contact phone number by pressing **Menu** and select “Contacts” and “Search” or by pressing down on the navigation buttons in standby mode.

Press  to call.

Save a phone number by pressing **Menu** then selecting “Contacts” and “Add contact”. Enter the name and number. When they are saved, press **Done**.

To call one of the last 20 phone numbers dialed by pressing , scrolling to the desired number and press  again.

▪ Speed dial

You can assign a speed dial number to a phone number by pressing **Menu**, selecting “Contacts” and “Speed dials” and then scrolling to the number button you want.

Press **Assign**, or if already assigned, press **Options** and select “Change”.

Press **Search** and select the name and number you want.

▪ Answering and rejecting calls

Press **[Answer]** to answer a call and **[Reject]** to reject or to end a call.

Press **Silence** to mute a ring tone.

If you receive a call during another call, press **[Answer]** to answer the second call and put the first call on hold. Press **[Reject]** to end the active call.

▪ Call options

These are the options you can choose from during a call (if available by your network provider):

“Mute” or “Unmute”, “End call”, “End all calls”, “Contacts”, “Menu”, “Hold” or “Unhold”, “Swap”, “New call”, “Send DTMF”, “Private call”, “Record”, “Answer”, “Reject”, “Loudspeaker”, “Handset”, and “Lock keypad”.

You can have up to 5 people on a conference call.

▪ Writing text

There are two methods to key in text: the traditional method and the predictive text method.

Press **#** to change between character cases (Abc, abc, ABC).

Press and hold **#** to change between numbers and letters.

Turn predictive text on and off by pressing **Options** and selecting “Dictionary” for predictive text method or “Dictionary off” for traditional text method.

The traditional method for typing text is to press a single button multiple times in quick succession to get the desired letter. (Example: press **2abc**, three times to get “c”)

The predictive method for typing text is to press each letter once and let the phone decipher the word. (Example: press **2abc**, **2abc**, **7pqrs** to write “car”)

Press **0** to go to the next word.

If the word is not correct, press **Option** for your options.

▪ **Keypad lock**

The keypad can be locked or unlocked by pressing **Menu** or

Unlock and ***+** within 1.5 seconds.

▪ **LED lights**

The LED lights are connected directly to the battery. This is done so your phone can be used as a flashlight even when the phone is turned off.

When taking a picture or video in low light conditions, press and hold the LED light button. Then press your picture or video options. (Press up on the navigation buttons in standby mode as a short cut to your camera functions.)

4. List of Menu Functions

Press **Menu** to access the menu, then press the navigation buttons to select the desired menu item.

Messages

- Text messages
- Multimedia msgs.
- E-mail
- Chat
- Voice messages
- Info messages
- Message settings
- Service commands

Call register

- Missed calls
- Received calls
- Dialed numbers
- Delete recent call lists
- Call duration
- GPRS data counter
- GPRS connection timer
- Message counter

Contacts

- Search
- Add contact
- Delete
- My presence
- Subscribed names
- Copy
- Settings
- Speed dials
- Voice tags
- Info numbers
- Service numbers

My numbers
Caller groups

Settings

Profiles
Tone settings
Display settings
Time and date settings
Personal shortcuts
Connectivity
Call settings
Phone settings
Chat and my presence settings
Enhancement settings
Security settings
Restore factory settings

Operator Menu

Gallery

Memory card
Images
Video clips
Music files
Graphics
Tones
Recordings

Media

Camera
Media player
Music player
Radio
Voice recorder
Media equalizer

Organizer

Alarm clock

Calendar
To-do list
Notes
Wallet
Synchronization

Applications

Games
Collection
Extras

Services

Home
Bookmarks
Download links
Last web addr.
Service inbox
Settings
Go to address
Clear the cache
Positioning

SIM services

Note: Not all menu items may be supported by your SIM card or service provider, or if no MMC card is inserted.

5. Battery Information

The phone receives its power from a rechargeable battery. The battery is at maximum performance only after 2 or 3 complete cycles of charge and discharge.

The battery can be charged hundreds of times but will eventually wear out. If you notice a big change in operating time, replace your battery with a new one.

Use only batteries that are approved by the phone manufacturer. Unplug the phone once it is completely charged. Never leave the phone plugged in for longer than a week. Overcharging may shorten the life of your battery. The battery will gradually discharge by itself over time.

Extreme temperatures can affect the performance of your battery. Use the battery only for its intended use and never use a damaged battery.

Do not short-circuit the battery. This can occur if a conductive object (e.g. metallic) contacts the terminals (+ and -) at the same time.

Do not leave your battery in hot or cold places; it may reduce the capacity and lifespan of your battery. Keep your battery between 15°C and 25°C (59°F and 77°F). A battery that is hot or cold may temporarily not work, even if fully charged.

Never discard your battery in a fire. Discard your battery according to local regulations.

6. Care and Maintenance

Keep your phone dry at all times. Moisture can damage your phone.

Do not place your phone in cold or hot places. Extreme temperatures can damage your phone.

Do not attempt to open your phone, non-expert handling can damage your phone.

Mobiado

www.mobiado.com