

WEEE Warning Message

Symbol for Separate Collection in European Countries

This symbol indicates that this product is to be collected separately.

The following apply only to users in European countries:

- This product is designated for separate collection at an appropriate collection point. Do not dispose of as household waste.
- For more information, contact the retailer or the local authorities in charge of waste management.



FCC STATEMENT

This device complies with Part 15 of the FCC Rules. Operation is subject to the following two conditions:

- (1). This device may not cause harmful interference, and
- (2). This device must accept any interference received, including interference that may cause undesired operation.

Note:

This equipment has been tested and found to comply with the limits for Class B digital devices, pursuant to Part 15 of the FCC rules. These limits are designed to provide reasonable protection against harmful interference in a residential installation. This equipment generates uses and can radiate radio frequency energy and, if not installed and used in accordance with the instructions, may cause harmful interference to radio communications.

However, there is no guarantee that interference will not occur in a particular installation. If this equipment does cause harmful interference to radio or television reception, which can be determined by turning the equipment off and on, the user is encouraged to try to correct the interference by one or more of the following measures:

- Reorient or relocate the receiving antenna
- Increase the separation between the equipment and receiver
- Connect the equipment into an outlet on a circuit different from that to which the receiver is connected

Use of shielded cable is required to comply with Class B limits in Subpart B of Part 15 of the FCC rules.

Do not make any changes or modifications to the equipment unless otherwise specified in the manual. If such changes or modifications should be made, you could be required to stop operation of the equipment.

Product Information

1. Product design and specifications are subject to change without notice. This includes primary product specifications, software, software drivers, and user's manual. This User Manual is a general reference guide for the product.
2. The product and accessories that come with your camera may be different from those described in this manual. This is due to the fact that different retailers often specify slightly different product inclusions and accessories to suit their market requirements, customer demographics, and geographical preferences. Products very often vary between retailers especially with accessories such as batteries, memory cards, cables, carrying cases/pouches, and language support. Occasionally a retailer will specify a unique product color, appearance, and internal memory capacity. Contact your dealer for precise product definition and included accessories.
3. The illustrations in this manual are for the purpose of explanation and may differ from the actual design of your camera.
4. The manufacturer assumes no liability for any errors or discrepancies in this user manual.
5. For driver updates, you can check the "Download" section of our website, www.geniusnet.com

SAFETY INSTRUCTIONS

Read and understand all **Warnings** and **Cautions** before using this product.

Warnings

- **If foreign objects or water have OKed the camera, turn the power OFF and remove the battery.**
Continued use in this state might cause fire or electric shock. Consult the store of purchase.
 - **If the camera has fallen or its case has been damaged, turn the power OFF and remove the battery.**
Continued use in this state might cause fire or electric shock. Consult the store of purchase.
-



- **Do not disassemble, change or repair the camera.**

This might cause fire or electric shock. For repair or internal inspection, ask retailer where you purchased it.



- **Do not use the camera in areas near water.**

This might cause fire or electric shock. Take special care during rain, snow, on the beach, or near the shore.



- **Do not place the camera on inclined or unstable surfaces.**

This might cause the camera to fall or tilt over, causing injury.



- **Keep the batteries out of the reach of children.**

Swallowing batteries might cause poisoning. If the battery is accidentally swallowed, immediately consult a physician.



- **Do not use the camera while you are walking, driving or riding a motorcycle.**

This might cause you to fall over or result in a traffic accident.



Cautions

- **Insert the batteries paying careful attention to the polarity (+ or -) of the terminals.**

Inserting the batteries with its polarities inverted might cause fire and injury, or damage to the surrounding areas due to the battery rupturing or leaking.



- **Do not fire the flash close to anyone's eyes.**

This might cause damage to the person's eyesight.



- **Do not subject the LCD monitor to impact.**

This might damage the glass on the screen or cause the internal fluid to leak. If the internal fluid OKs your eyes or comes into contact with your body or clothes, rinse with fresh water.

If the internal fluid has OKed your eyes, consult a physician to receive treatment.



- **A camera is a precision instrument. Do not drop it, strike it or use excessive force when handling the camera.**

This might cause damage to the camera.



- **Do not use the camera in humid, steamy, smoky, or dusty places.**

This might cause fire or electric shock.



- **Do not remove the battery immediately after long period of continuous use.**

The battery becomes hot during use. Touching a hot battery might cause burns.



- **Do not wrap the camera or place it in cloth or blankets.**

This might cause heat to build up and deform the case, resulting in fire. Use the camera in a well-ventilated place.



- **Do not leave the camera in places where the temperature may rise significantly, such as inside a car.**

This might adversely affect the case or the parts inside, resulting in fire.



- **Before you move the camera, disconnect cords and cables.**

Failure to do this might damage cords and cables, resulting in fire and electric shock.



Notes on Battery Usage

When you use the battery, carefully read and strictly observe the **Safety Instructions** and the notes described below:

- Use only the specified battery
- Avoid using the battery in extremely cold environments as low temperatures can shorten the battery life and reduce camera performance.
- When you are using the new rechargeable battery or rechargeable battery that has not been used for an extended period of time (the battery that passed the expiry date is an exception) might affect the number of images that can be captured. Therefore, to maximize its performance and lifetime, we recommend that you fully charge the battery and discharge it for at least one complete cycle before use.
- The battery may feel warm after long period of continuous use of the camera or the flash. This is normal and not a malfunction.
- The camera may feel warm after long period of continuous use. This is normal and not a malfunction.
- If the battery is not to be used for a long period of time, remove it from the camera to prevent leakage or corrosion.
- If the battery is not to be used for a long period of time, store it after no battery power left. If the battery is stored for a long time in a fully charged state, its performance may be impaired.
- Always keep the battery terminals in a clean state.
- Risk of explosion if battery is replaced by an incorrect type.
- Dispose of used batteries according to the instructions.
- We recommend the battery should be charged 8 hours for first time use.

CONTENTS

GETTING TO KNOW YOUR CAMERA	8
OVERVIEW	8
STANDARD ACCESSORIES	8
FRONT VIEW	9
KEYPAD ILLUSTRATION	9
SIDE VIEW	10
TOP VIEW	10
BOTTOM VIEW	10
GETTING STARTED	11
INSTALLING THE BATTERY	11
INSERTING AND REMOVING AN SD CARD	11
RECORD MODE	12
BUTTON FUNCTION	12
LCD MONITOR INFORMATION	13
H.264 MOVIE RECORDING	14
PICTURE RECORDING	14
USING DIGITAL ZOOM	14
MENU MODE	14
MENU MODE	15
MENU MODE	16
<i>Mode set</i>	<i>16</i>

<i>Video Size</i> _____	16
<i>Possible recording time / sec (video clip)</i> _____	16
<i>Possible number of shots (still image)</i> _____	16
IMAGE SIZE _____	17
<i>Select Image size for the image resolution.</i> _____	17
QUALITY _____	17
METERING _____	17
EFFECT _____	18
EIS _____	18
SET UP _____	18
MODE/PLAYBACK _____	20
PLAYBACK MODE _____	20
MP3/ PMP/ VOICE RECORDING/MOTION DETECTION /E BOOK MODE _____	20
TRANSFER MP3 MUSIC TO THE CAMERA _____	20
<i>How to use MP3</i> _____	20
PMP MODE _____	21
MOTION DETECTION MODE _____	21
<i>Trimming</i> _____	22
<i>Display image information</i> _____	22
<i>Protect</i> _____	22
<i>Slide Show</i> _____	22
<i>Delete</i> _____	23
<i>Copy to Card</i> _____	23
<i>Resize</i> _____	23
<i>Rotate</i> _____	23
DELETE BUTTON _____	24
VIEWING MOVIE ON PC _____	25
SYSTEM REQUIREMENT _____	25

ARCSOFT MEDIAIMPRESSION	28
CONNECTING YOUR CAMERA TO A COMPUTER	36
<i>Web Camera Mode</i>	36
SPECIFICATIONS	37
TROUBLESHOOTING	38

Getting to Know Your Camera

Overview

Thank you for purchasing the new digital video camera!

This multi-function digital video camera with a 5 Mega Pixel CMOS sensor can take H.264 movies which videos can be taken with in certain amount of memory. High quality images with up to 11 mega pixels can also delivered smoothly. With a color LCD monitor, users can compose images and examine them easily. The G-Shot HD520 can also connect DV to a HDTV by HDMI cable, and easily playback recorded high-definition videos on the wide screen of an HDTV.

Other features provided by this camera include the following:

- True 5.0 Mega pixel CMOS sensor
- H.264 Digital Video Camera
- Voice Recorder
- Music Player
- Security Motion Detection
- Web Camera
- Stabilization
- 5X Digital Zoom
- 2.5" LTPS LCD
- Supports up to 8GB SD Card
- Face Detection
- Z-Lighting

Standard Accessories

Unpack the package and make sure all standard accessories listed below are included:

- Digital Video Camera
- USB Cable
- AV out Cable
- HDMI Cable
- CD-ROM
- Lithium-ion Rechargeable Battery
- Power adaptor
- AC Plug Adaptor for EU to US
- Earphone
- Pouch & Strap
- Quick Guide

Warranty Card

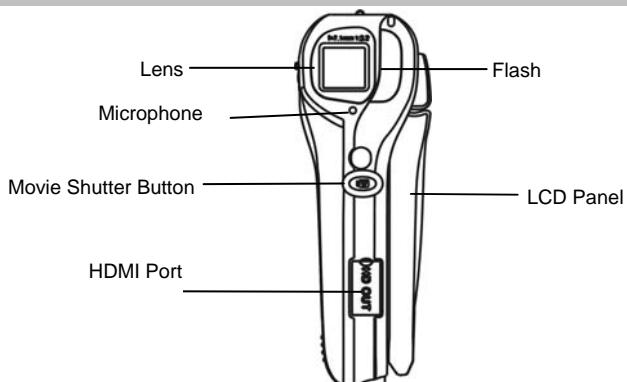
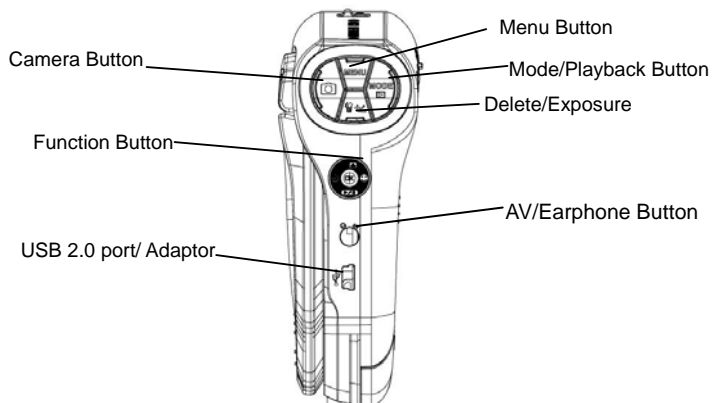
Front View**KeyPad illustration**

Side View

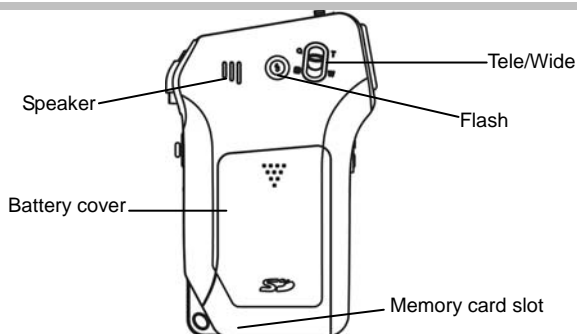

Top View

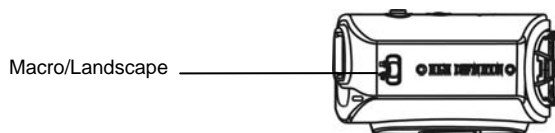

Bottom View

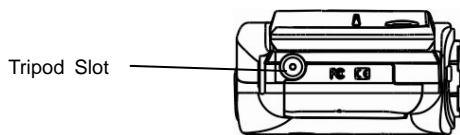

Getting Started

Installing the Battery

Before using the camera, you must insert the NP60 rechargeable Li-ion Battery.

1. Follow the arrow direction and slide it outwards to remove the battery cover.
2. Insert the batteries according to the correct polarity marks (+ or -).
3. Close the battery cover firmly.

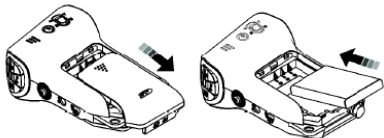

Inserting and Removing an SD Card

The camera comes with internal memory (64MB) which allows you to store pictures, movies, recorded voice and music. You can expand the memory capacity by using an optional SD memory card up to 8GB. To insert a memory card:

1. Insert the memory card into the correct position.
2. To remove an installed SD card, press the card inwards to release it.
3. When the card pops out, gently remove it from its slot.











NOTE

- When a memory card is being used, movies and pictures are saved on the card rather than the built-in memory.

Record Mode

Button Function

	Power Button: Press down for one second to turn on or turn off the camera.
	Movie Shutter Button: 1. Press Start to take a movie, or record voice. 2. To stop recording, press it again.
	OK Button: Used to move cursor to sub menu or confirm action. OK (down): Down play and pause button: Press the OK button down to play and pause for playing Movie clip and voice. Self-timer enabled Z-Lighting: Press the OK button up for Z-Lighting to deal with very high contrast scenes in dark and bright areas. Face Detection Press the OK button to the right for the face detection function.
	MENU: Press menu to start the menu setting. MODE: Press Mode to select the sub menu functions. Delete/+/-: Delete the file or adjust White Balance and exposure. Take a picture
	Tele/Wide Button: Digital Zoom in and out.
	Flash Mode:  Auto Flash: the flash fires automatically according to light conditions. Use this mode for general photography.  Fill-in Flash: the flash will fire for every shot taken.

	<p>Flash Off, the flash will not fire under any circumstances. Use this mode when taking images in a place where flash photography is prohibited, or when the subject is distant (beyond the range of the flash).</p> <p>Slow Sync: The flash will fire and the camera will set the shutter speed at proper speed.</p>
	<p>Macro switch: Switch between Macro Mode and Normal Mode.</p> <p>Focus range : Macro :20 cm Normal : 1.2m ~ Infinity</p>

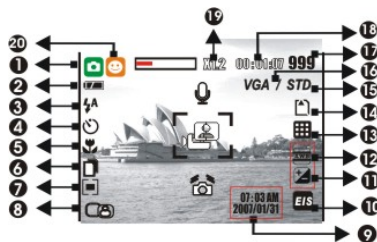

LCD Monitor Information

The indicators below will display on the LCD when movies and pictures are recorded:



<p>1 Working Mode & Scene Mode</p> <ul style="list-style-type: none"> (Auto) Auto (P) Program (S) Down (A) Auction (V) Voice Recording (PMP) PMP (P) Playback (MP3) MP3 (M) Motion Detection (B) Bookicon 	<p>3 Flash Mode</p> <ul style="list-style-type: none"> (A) Auto Flash (F) Fill-in Flash (S) Slow Sync (O) Flash Off <p>4 Self-timer</p> <ul style="list-style-type: none"> (10) 10 Seconds (2) 2 Seconds (D) Double <p>5 Focus Range</p> <ul style="list-style-type: none"> (M) Macro 	<p>8 Z-Lighting</p> <ul style="list-style-type: none"> (Z) Z-Lighting <p>9 Time & Date</p> <p>10 Electrical Image Stabilizing</p> <p>11 Exposure $\pm 2EV$</p> <p>(0.5EV/Steps)</p> <p>12 White Balance</p> <ul style="list-style-type: none"> (Auto) Auto (Daylight) Daylight (Cloudy) Cloudy (Sunset) Sunset (Fluorescent) Fluorescent (Tungsten) Tungsten (Custom) Custom 	<p>13 Image Quality</p> <ul style="list-style-type: none"> (S) S.Fine (F) Fine (N) Normal <p>14 Memory Card</p> <p>(MC) Memory Card</p> <p>15 Image Size</p> <ul style="list-style-type: none"> (H) HIGH (11M) (S) STANDARD (5M) (L) LOW (VGA) <p>16 Video Size</p> <ul style="list-style-type: none"> (HD) HD (720 x 480) (VGA) VGA (640 x 480) (WEB) WEB (320 x 240) 	<p>17 Estimated Available Shots</p> <p>18 Estimated Available Video Time</p> <p>19 Zoom IN/Out Indicator</p> <p>20 Face Detection</p>
<p>2 Battery Status</p> <ul style="list-style-type: none"> (Full) Battery Full (Half) Battery Half (Drained) Drained (In Charging) Battery Drained In Charging (Charging) Charging 	<p>6 Shooting Mode</p> <ul style="list-style-type: none"> (S) Single (C) Continuous <p>7 Metering</p> <ul style="list-style-type: none"> (Multi) Multi (Spot) Spot 			

H.264 Movie Recording

Press the Movie Shutter button () to start recording. When a movie is recording, a time indicator will display on the LCD monitor. To stop recording, press the Movie Shutter Button () again.

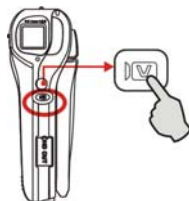

Picture Recording

Press the Picture Shutter Button () to take a picture.



Using Digital Zoom

The digital zoom magnifies the images when recording movies or taking pictures.

1. To zoom in/out, press the Tele/Wide Button.
2. The digital zoom can be set from 1x to 5x and the magnification ratio is shown on the LCD monitor.

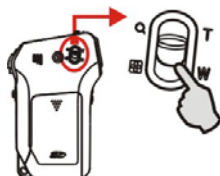

MENU MODE

MODE SET	VIDEO SIZE	IMAGE SIZE	QUALITY	METERING
<ul style="list-style-type: none"> • AUTO • PROGRAM • DAWN • AUCTION • EXIT 	<ul style="list-style-type: none"> • HD1280X 720) • TV (640 x 480) • Web (320 x 240) • EXIT 	<ul style="list-style-type: none"> • HIGH (11M) • STANDARD (5M) • LOW (VGA) • EXIT 	<ul style="list-style-type: none"> • S.FINE • FINE • NORMAL • EXIT 	<ul style="list-style-type: none"> • MULTI1 • SPOT • EXIT
SHOOTING	EFFECT	OSD INF.	EIS	SETUP
<ul style="list-style-type: none"> • SINGLE • CONTINUOUS • EXIT 	<ul style="list-style-type: none"> • Normal • B/W • Sepia • Negative • RGB • EXIT 	<ul style="list-style-type: none"> • OFF • BASIC • DETAIL • GRID 3X3 • GRID 6X4 • EXIT 	<ul style="list-style-type: none"> • OFF • ON • EXIT 	<ul style="list-style-type: none"> • S. Sound • SH. Sound • SYS.VOLUME • Q.VIEW • PWR SAVE • IMPRINT • DATE & TIME • LANGUAGE • FILE • USB • VIDEO • FREQ. • RESET ALL • FORMAT • EXIT

Menu Mode

Mode set

1. Press the Menu button to open the menu setting,
2. Use the OK button up and down to move to the sub menu, and use press it right and left to move between main menus.
3. Press OK to confirm the option you select.
4. Press MENU to exit.
5. There are four options.
 - AUTO
 - PROGRAM
 - DAWN
 - AUCTION



Video Size

Select Video Size for Movie Clip size when recording.

- HD
- VGA
- WEB

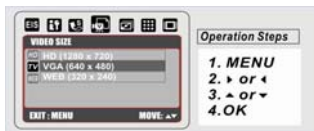

Possible recording time / sec (video clip)

Quality	SD memory Card capacity					
	256MB	512MB	1GB	2GB	4GB	8GB
HD	00:05:09	00:10:33	00:21:11	00:42:39	01:23:22	02:47:25
TV	00:14:15	00:29:33	00:58:39	01:58:07	03:50:52	07:43:35
WEB	00:46:35	01:35:30	03:11:39	06:25:55	12:34:19	23:59:59

Possible number of shots (still image)

Quality	32 MB internal memory	SD memory Card capacity						
		128 MB	256 MB	512 MB	1GB	2GB	4GB	8GB
11MP	1	45	91	187	377	759	1484	2980
5MP	3	98	198	405	814	1640	3206	6437
VGA	29	820	1650	3383	6788	9999	9999	9999

IMAGE SIZE

Select Image size for the image resolution.

- HIGH (11M)
- STANDARD (5M)
- LOW (VGA)
- EXIT



QUALITY

Select Quality to set the appropriate compression ratio for the captured and recorded images.

- S.FINE
- FINE
- NORMAL
- EXIT

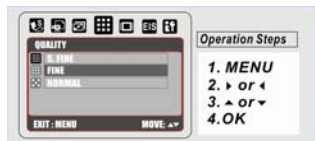

METERING

Metering gives you more superior exposure conditions and a brighter picture.

- Multi Metering

Exposure will be evaluated according to the average of the available light source in the image area; this is suitable for general use.

- SPOT

If the subject is against the light source or has little contrast, use this function to make the subject brighter.

- EXIT

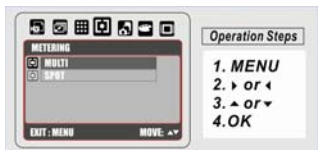

SHOOTING

- SINGLE
- CONTINUOUS

You can have the continuous shooting by pressing and holding the shutter button and ending it by releasing the shutter button.

- EXIT

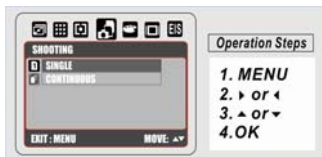

EFFECT

- Normal
- B/W
- Sepia
- Negative
- RGB
- EXIT

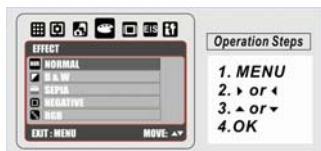

OSD INF.

- OFF
- BASIC
- DETAIL
- GRID 3X3
- GRID 6X4
- EXIT



EIS

EIS can only be used in Movie Recording. If you prefer to record a movie not using EIS, turn it OFF to cancel the setting.

- OFF
- ON
- EXIT

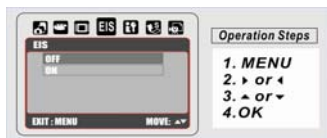

SET UP

Enter SET UP mode by pressing the Menu Button and pressing the OK button to select SETUP.

- S. Sound/SH. Sound

Select the sound you prefer and press the OK button to confirm the setting. Or you can select "OFF" to turn off the start up sound.

- SYS.VOLUME

Select the volume you prefer and press the OK button to confirm the setting. Or you can select "OFF" to turn it off.

- Q.VIEW

Select the time you prefer and press OK button to confirm the setting. Or you can select "OFF" to turn off the Quick View Time.

- PWR SAVE

Select the time you prefer for the power saving mode and press OK button to confirm the setting. Or you can select "OFF" to disable the power saving functions.

- IMPRINT

The function allows you to print the date or date & time on the image.

- **DATE & TIME**

Select the type of date and time.

- **LANGUAGE**

1. English	6. Italian	11. S. Chinese
2. Japanese	7. Turkish	12. T. Chinese
3. French	8. Russian	13. Arabic
4. German	9. Thai	
5. Spanish	10. Portuguese	

- **FILE**

This setting allows you to name the files.

If RESET is selected, the next file name will be set from 0001 even after formatting, deleting all, or inserting a new memory card.

If SERIES is selected, the file name will follow the latest stored file name installed.

- **USB**

Computer	If computer is selected, the camera turns off the LCD Monitor and automatically connects to your PC.
Printer	If printer is selected, the camera lets you to select the detail options of printer setting via the PictBridge function when the printer is connected.
PC CAM	Install the PC CAM function after you open MSN Messenger or AMCAP.

- **VIDEO**

NTSC	U.S.A, Canada, Japan, South, Korea, Taiwan, Mexico
PAL	Australia, Austria, Belgium, China, Denmark, Finland, Germany, UK, Italy, Kuwait, Malaysia, New Zealand, Singapore, Spain, Sweden, Switzerland, Thailand, Norway.

- **FREQ.**

50Hz	UK, Germany, Italy, Spain, France, Netherlands, China, Japan, Portugal.
60Hz	USA, Taiwan, Korea, Japan

- **RESET ALL**

The option resets all default settings except for Date, Time, Language and Light Freq.

- **FORMAT**

This function allows you to format the memory card or the built-in flash memory.

- **EXIT**

Mode/Playback

Playback Mode

Press the Mode/Playback Button, then press the OK button to go to last still image, movie clips, or voice clip that are stored in the memory.

1. Select an image that you want to playback by moving the OK left or right.
2. For movies, press the OK button down to play a movie. Hold the OK button left or right to go backward/forward through the movie.



MP3/ PMP/ Voice Recording/Motion Detection /E Book Mode

Press the Mode/Playback Button, and press the OK button up/down to select this mode. Press OK button again to enter the mode above you select.



Transfer MP3 Music to the camera

1. Connect your camera to the computer USB port.
2. Transfer MP3 music to My Computer\Removable Disk\MP3.
3. If you can't find the MP3 folder from the SD card, format the SD card first.
4. Once all the music is transferred, disconnect the USB cable from the PC.



How to use MP3

1. Press the mode button and select MP3 mode by pressing the OK button.
2. Select the folder where you stored the digital music files.
3. Select the music file you would like to play by pressing the OK button up or down and start playing the song by pressing the OK button.
4. The music can be played from the built-in speaker or an earphone. If you use the earphone, connect the earphone to the earphone jack.



PMP Mode

Under this mode you can view all the still images and movie clips recorded by this camera or other cameras or other devices (all files must be converted by ArcSoft MediaImpression included in the CD-ROM.)

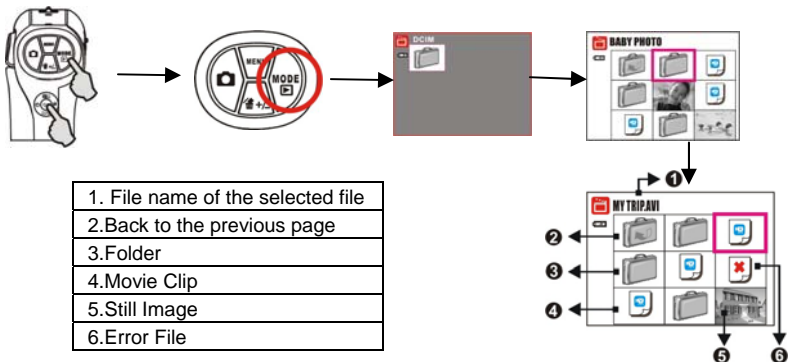

Motion Detection Mode

Motion detection can record anything that happens when you are not around your camera. It will start recording when any movement is detected by AE bar.

1. In motion detection mode, press Menu button to set the Tele/Wide, Video Size, EIS, Quality, Metering and Effect.
2. After the above setting, Motion Detection is in standby mode and will start recording when the light value (LV) reaches LV 0.1~0.2 and varies for 3sec.
3. Stop the recording by pressing the OK button down and continue recording by pressing the OK button down again.
4. If you don't move the camera for 5 sec, Motion detection will stop recording and save as a movie clip file. Or you can press the Movie Shutter button to stop recording.



1. In standby



2. Start recording

Trimming

1. Select an image.
2. Slide the T Button (Q) or W Button (W) to select the size of the enlargement.
3. Press OK button and select "TRIM" and press the OK Button again to confirm the request.
4. The camera will save the trimmed image as a new image after you confirm the request.



Display image information

1. Select an image.
2. Press and hold the Flash Button (F) to show the image information. Press the flash Button again to cancel the information display.

Protect

1. Press the Menu Button to select "Protect"
2. Move to "Select" and press OK.
3. Select one image and press T (Q) button, and protect will show on the LCD display when the protection is set.
4. Press OK Button to confirm the request for the protection of the selected images.
5. To cancel the protection, press T Button or W Button again.



Slide Show

Press the Menu Button to enter the menu and select "SLIDE".

There are three options: After you complete the Interval and Effect setting, go to Show and select PLAY/REPEAT to start the slide show.

Show: Start the slide show after you set Interval or Effect.

Interval: Select the interval time between each still image.

Effect: Four kinds of effects (B&W, Sepia, Negative, RGB) are available. Move the OK button up or down to select the effect.



Delete

You can delete the selected image or all images.

Copy to Card

Copy the images stored in the internal flash memory to the memory card.

Resize

Resize a still image.

1. Select the image and select Resize.
2. Press OK button and select RESIZE.
3. Select the image size you prefer and press OK to confirm.
4. The resized image will be stored as a new image.
5. Select USER IMAGE 1 & 2 as the start-up image and refer to "Start-Up Image" under set up mode.

Rotate

You can rotate the image in the following directions:

1. RIGHT 90 degrees
2. LEFT 90, 180 degrees
3. Horizontal
4. Vertical.



Delete Button

Press  button to delete the photo you want to cancel under playback mode.

To change White Balance / Exposure Value setting:

1. In menu mode, select MODE SET and move to PROGRAM.
2. Press delete, and press OK to move UP/DOWN to choose white balance or Exposure Value. Press OK button to move RIGHT/LEFT to select seven values of white balance between from -2.0 ~ +2.0.
3. Press OK button to confirm the setting and exit.



Viewing Movie on PC

When playing a movie for the first time, Video Codec should be installed in the PC. To do this:

Insert the CD-ROM into the computer's CD-ROM drive. Click "Arcsoft Media Impression" and follow the on-screen instructions to complete the installation.

System Requirement

Windows

Windows 2000/XP/Vista,

Pentium III 800MHz or higher

256MB RAM

CD ROM

1GB free HDD space

Available USB port

Macintosh

Mac G3 or later

MAC OS 10.0 above

256MB RAM

CD ROM

1GB free HDD space

Available USB port

Viewing Pictures and Movies on a TV

Connecting to a high-definition TV

1. Connect HDMI cable to a HD TV
2. Set video input source of a TV to "HDMI" option.
3. The steps for viewing stored pictures and movie on a TV are exactly the same as for viewing them on the LCD monitor.

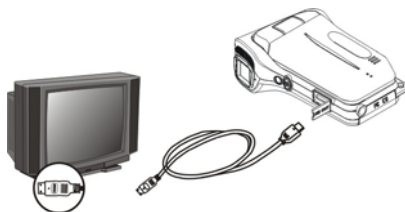

Connecting to a non-high-definition 16:9 (Wide) or 4:3 TV

1. Connect one end of the AV cable to your camera's AV out port.
2. Connect the other end of the cable to a television.
3. The option menu of Earphone/TV pops out on the LCD Screen.
4. Choose TV option and press OK button to validate the setting.
5. The steps for viewing stored pictures and movie on a TV are exactly the same as for viewing them on the LCD monitor.



ArcSoft MediaImpression

1. Install ArcSoft MediaImpression
2. Click Start → Select Programs→ArcSoft MediaImpression
3. Media Impression main Screen will appear on your desktop
4. Select the Video file you want to play



Uploading Video Files to YouTube

The bundled software CD contains Arcsoft MediaImpression which features uploading the recorded videos to YouTube. It will help you can share them with your family and friends on YouTube website. Also bundled Youtube-Link software inside camera which allows uploading your favorite video to Youtube web site easily.

Arcsoft MediaImpression

To upload video files to YouTube:

1. Install Arcsoft MediaImpression
2. Click [Start] [Select Programs] [Acrsoft MediaImpression]
3. Arcsoft MediaImpression main Screen will appear on your desktop.
4. Click [Video] Option.

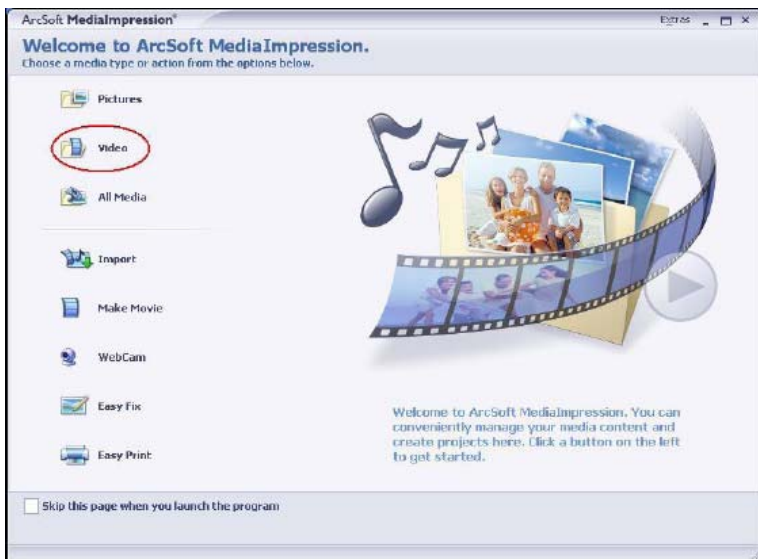

5. Select the video file you want to upload and click [Upload to YouTube] option at the bottom menu.

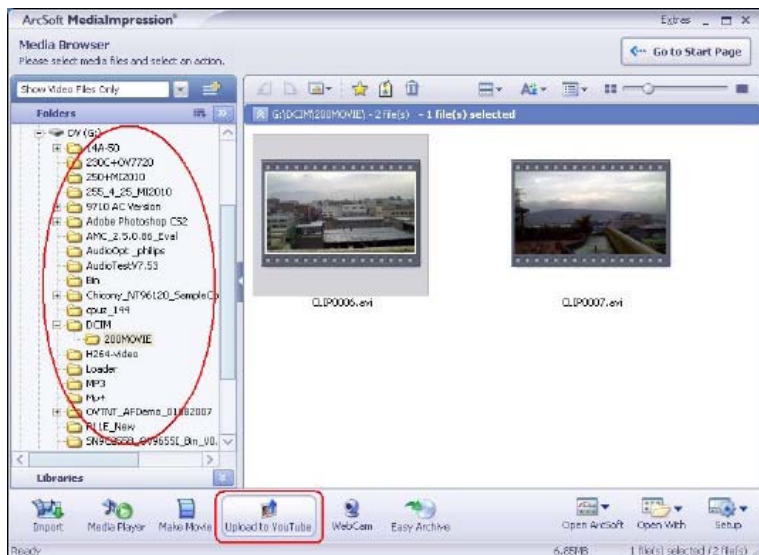

6. If this is your first using this function, please follow the instruction on YouTube Setting Panel.

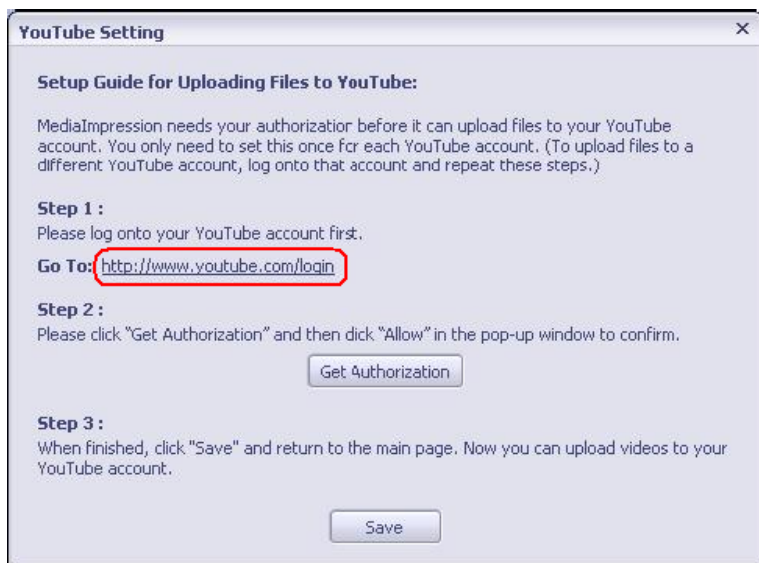

7. Go to <http://www.youtube.com/login>, then Log onto your YouTube account.



(If you do not have YouTube account, sign up here first.)

8. After you log onto your YouTube account, Click [Get Authorization] button below.

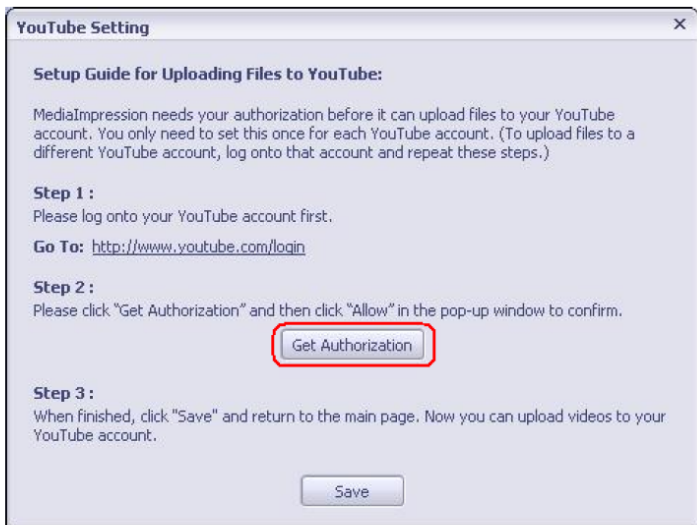

Then, Click [Allow] Button shown on YouTube website.

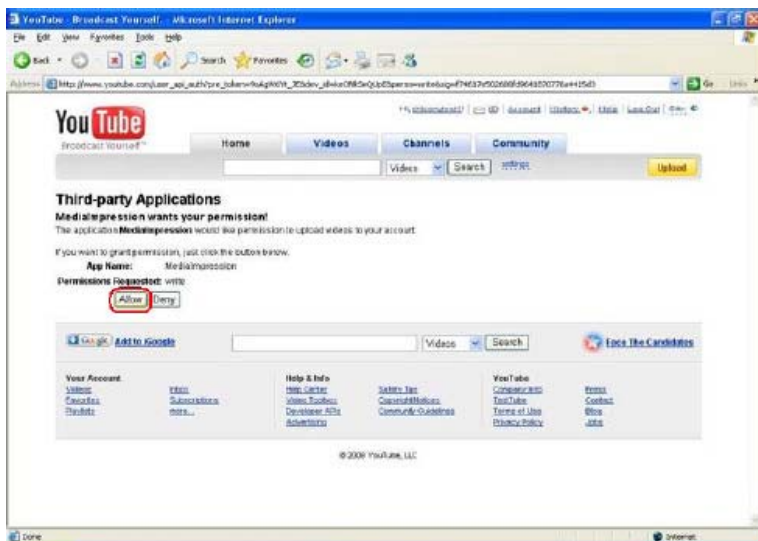

9. Click [Save] Button to upload the video.



Connecting Your Camera to a Computer

You can transfer pictures, movies or voice recordings stored on your camera to a computer and send them in emails to friends or post them on websites. To do this you should:

1. Connect the computer and camera with the supplied mini USB cable.
2. Default mode is Mass Storage Mode when the camera connects to PC
3. Transfer pictures or movies or MP3 or voice recordings.

Web Camera Mode

1. Install the PC Camera Driver in your computer.
2. Press the Menu button and go to Setup by select USB setting as PC Cam and press OK Button.
3. Connect the camera with PC by the supplied USB Cable
4. The Camera will automatically go to the PC Cam mode and turn off LCD display.

Specifications

Item	Description
Image Sensor	5 Mega Pixel CMOS Sensor
Lens	F3.2 (f=7.0mm)
Focus Range	Macro: 20cm; Normal: 200cm~infinite
LCD monitor	2.5" LTPS LCD
Digital Zoom	5X
Shutter Type	Electronic, 1/8000-1/4 sec
Storage Media	32 MB built-in memory, SD Card expandable up to 8GB
Image Resolution	High: 3824 x 2864 Standard: 2560 x 1920 Low: 640 x 480
Movie Resolution	HD 1280 x 720, 30fps VGA 640 x 480, 30fps QVGA 320 x 240, 30fps
White Balance	Auto/Manual (Daylight, Cloudy, Fluorescent, Tungsten, sunset, custom)
Exposure	Auto/Manual +/- 2
Self-Timer	2 sec, 10 sec, double
Flash	Auto, Fill-in flash, Slow sync, Flash off Working range :1.0 ~2.0M Charger time : Approx. 5 sec
File Format	Photo: JPEG Video: AVI (H.264) Voice: WAV Music: MP3
Image Play	Single Image/Effect
Interface	Mini USB 2.0/ TV Out
TV Output	NTSC/PAL

Battery type	Lithium-ion Rechargeable Battery
Dimensions	40(H) x 73(W) x 113(D) mm
Weight	160g (without battery)

Troubleshooting

Refer to the symptoms and measures listed below before sending the digital video camera for repairs. If the problem persists, contact your local reseller or service OK.

Power Supply

Symptom	Cause	Measure
The power does not come on.	The battery is not loaded.	Load the battery correctly.
	The battery is exhausted.	Recharge or use the AC power adapter.
	The AC power adaptor is not connected correctly.	Reconnect it properly.

Symptom	Cause	Measure
The power cuts out during use.	The digital video camera was left unattended and unused, so the auto powers off cuts it off.	Turn the power back on.
	The battery is exhausted.	Recharge or use the AC power adapter.
The power does not go off.	Digital video camera malfunction.	Reload the battery. If using the AC power adapter, reconnect it.
The battery runs out quickly.	It is being used in extreme low temperature.	Please don't use this camera under extreme low temperature.
	Many images are being captured in dark places inside, requiring flash.	Please prepare extra batteries if you need take a lot of images with flash.
	The battery is not fully charged. The battery is not used for an extended period of time	Fully charge the battery and discharge it for at least one complete cycle before use to maximize its performance

	after charged.	and lifetime.
The battery or digital video camera feels warm.	Long period of continuous use of the digital video camera or the flash.	Please turn off the camera if you don't use it.

Shooting

Symptom	Cause	Measure
Even if I press the shutter button, the digital video camera does not shoot.	The battery is running low.	Recharge or use the AC power adapter.
	The power is not on.	Turn the power on.
	The digital video camera is not in shooting mode.	Slide the mode switch to shooting mode.
	The shutter button is not pressed all the way.	Press the shutter button all the way.
	The internal memory or memory card does not have any free space.	Load a new memory card, or delete unwanted files.
	End of memory card life.	Load a new memory card.
	The flash is recharging.	Wait until the system LED off.
	The memory card is unrecognized by the digital video camera.	Format the memory card in this digital video camera before its first use or when it was used other than this digital video camera.
	The auto power off function is activated.	Turn the power on again.
Images do not appear on the LCD monitor.	The power is not on.	Turn the power on.
	The LCD monitor is dark.	Adjust the brightness of the LCD monitor in the SYSTEM MENU.
Although it is set to Auto Focus, it does not focus.	The lens or Self-timer LED is dirty.	Wipe clean with a soft, dry cloth or lens paper.
	The distance to the subject is smaller than the effective range.	Get your subject within the effective focus range.

Symptom	Cause	Measure
The flash does not fire. The flash cannot recharge.	The flash is set to flash off.	Set the flash to something other than flash off mode.

Symptom	Cause	Measure
Even though the flash fired, the image is dark.	The distance to the subject is greater than flash effective range.	Get closer to your subject and capture.
The image is too dark.	The image was captured in a dark place while set to flash off.	Set the flash to something other than flash off mode.
	It is under-exposed.	Set the exposure compensation to a larger value.
The image is too bright.	It is over-exposed.	Set the exposure compensation to a smaller value.
The image lacks natural color.	The image was captured in conditions that are hard for Auto White Balance to adjust to.	Add a white object to the composition.

Playback

Symptom	Cause	Measure
Cannot playback.	It is not set to playback mode.	Slide the mode switch to playback mode.
The contents of memory card cannot be replayed.	You played back a memory card that was not formatted by this device.	Loaded a card that was formatted and stored on by this device.
Files cannot be deleted.	The file is protected.	Cancel protection.
	You played back a memory card that was not formatted by this device.	Loaded a card that was formatted and stored on by this device.

Symptom	Cause	Measure
Cannot format a memory card.	The memory card is write-protected.	Remove the write-protection.
	End of memory card life.	Load a new memory card.
The playback image is dark though I used the flash.	The LCD monitor is too dark.	Adjust the brightness of LCD monitor in the SYSTEM MENU.

Other Problems

Symptom	Cause	Measure
Cannot load the memory card.	The card is facing the wrong way.	Load correctly.
Even when the digital video camera's buttons are pressed, it does not operate.	The battery is running low.	Recharge or use the AC power adapter.
	Digital video camera malfunction.	Turn the power off and remove the battery once, and try again.
The date and time is wrong.	The correct date and time is not set.	Set the correct date and time.
The date set has disappeared.	The battery is removed with the power still on.	Set the date and time again.

About connecting to your computer/software

Symptom	Cause	Measure
Cannot download files.	The free space on the hard disk drive of your computer may be insufficient.	Check whether the hard disk drive has enough space for running Windows, and if the drive for loading files has a capacity at least that of the memory card inserted in the digital video camera.
	No power supply.	Recharge the battery or use the AC power adapter or turn the power on.