



CREATE BY JASON WU

QUICK START GUIDE

Learn About Your CREATE

※ Buttons illuminate only when their functions are enabled

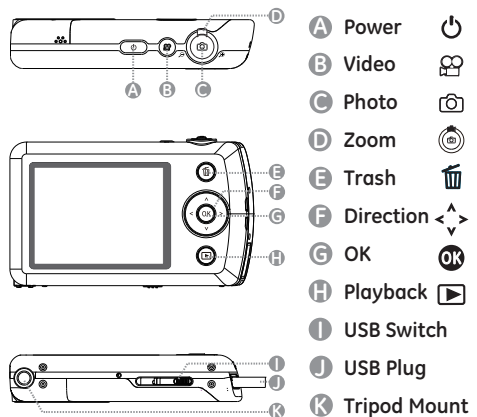

Initial Setup

Press Power to turn camera on, then use the Direction button to select your preferred language

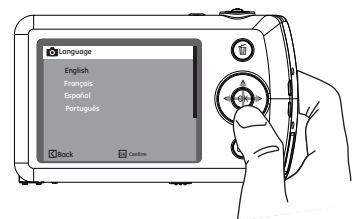

Press OK to confirm selection

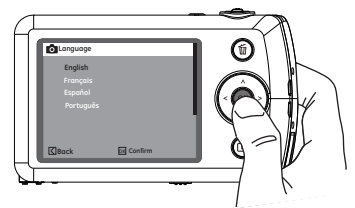

Repeat same steps to setup Date / Time

Taking Photos

Rotate Zoom wheel to zoom in / out

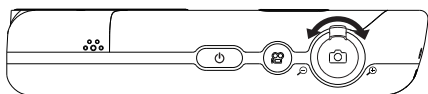

Press Photo halfway to focus, and then completely depress to take photo

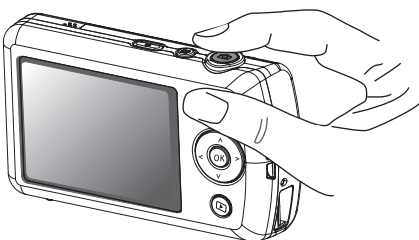

Flash And Self-timer

While taking photos: Press Left to switch between

- Auto Flash
- Flash Off
- Flash On

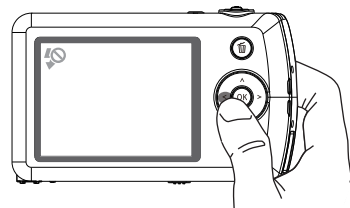

Press Right to turn on 10 second self-timer

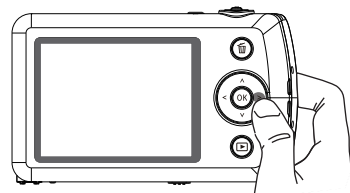

Recording Video

Press Video to start / stop recording

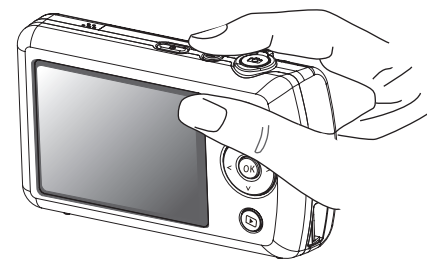

Playback

Press Playback to view photos / videos

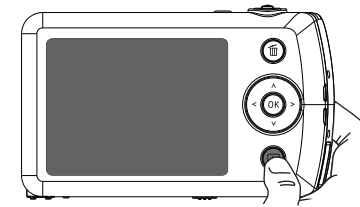

Rotate Zoom wheel to switch between Single Photo, Thumbnail, and Date Folder views

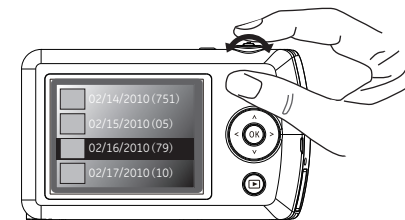

Reset

If your camera does not respond, you can reset it by holding down the Power and Video buttons at the same time and hold for 5 seconds.

Playback Options

During single photo / video playback, press OK to view playback options

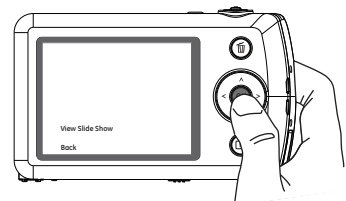

Press Up Down to switch between View Slide Show, Photo Touch-up, and Back selection

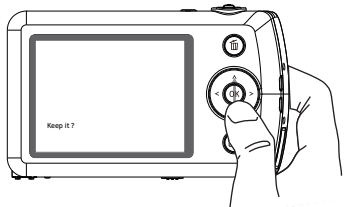

Press OK to confirm selection

Delete Photo / Video

During photo / video playback, press Trash to delete then press Down then OK to confirm deletion

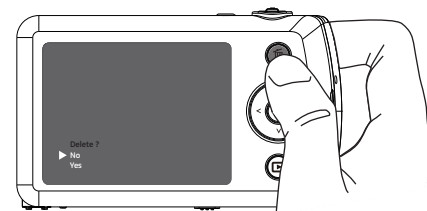

Enter Main Menu

Hold down OK, and then turn on camera to enter main menu

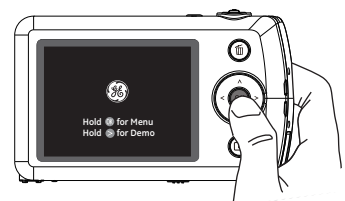

Use the Direction buttons to select setup options, and press OK to confirm your selection

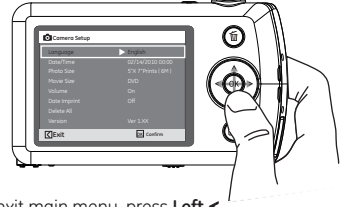

To exit main menu, press Left

View Camera Demo

Hold down Right, and then turn on camera to view demo

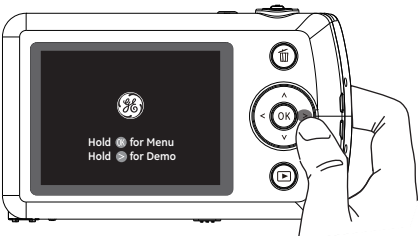

Connect To Computer And Share

Lightly press USB Switch to slide out the USB Plug

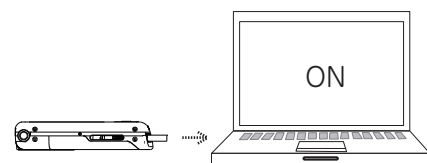

Plug camera into USB port on computer, then follow instruction prompts on your computer screen.



Recharging Camera

To charge, Plug camera into USB port on computer

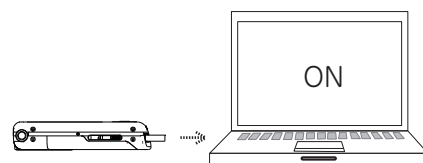

Or plug into the optional wall or usb cable adapter (included).

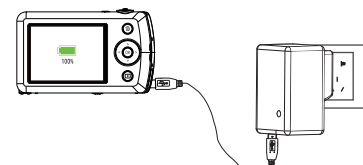

Summary Table

To	Select
Turn camera on / off	Press Power
With camera on, to ...	
Take photo	Press Photo
Start / stop recording video	Press Video
Zoom in / out	Rotate Zoom wheel
Turn flash on / off	Press Left
Set self-timer	Press Right
Playback photos / videos	Press Playback
Switch between playback views	Rotate Zoom wheel during playback
View slide show / photo touch-up	Press OK during playback
Delete photos / videos	Press Trash during playback
To	Select
Enter main menu	Hold down OK while turning on camera
View demo	Hold down Right while turning on camera
Connect to computer/printing station	Slide out USB Plug and plug it into USB port
Recharging camera	Slide out USB Plug and plug it into USB port on computer or AC adapter
Reset camera	Hold down Power and Video simultaneously for 5 seconds